

Spare Parts RSV-3

231 5160-001

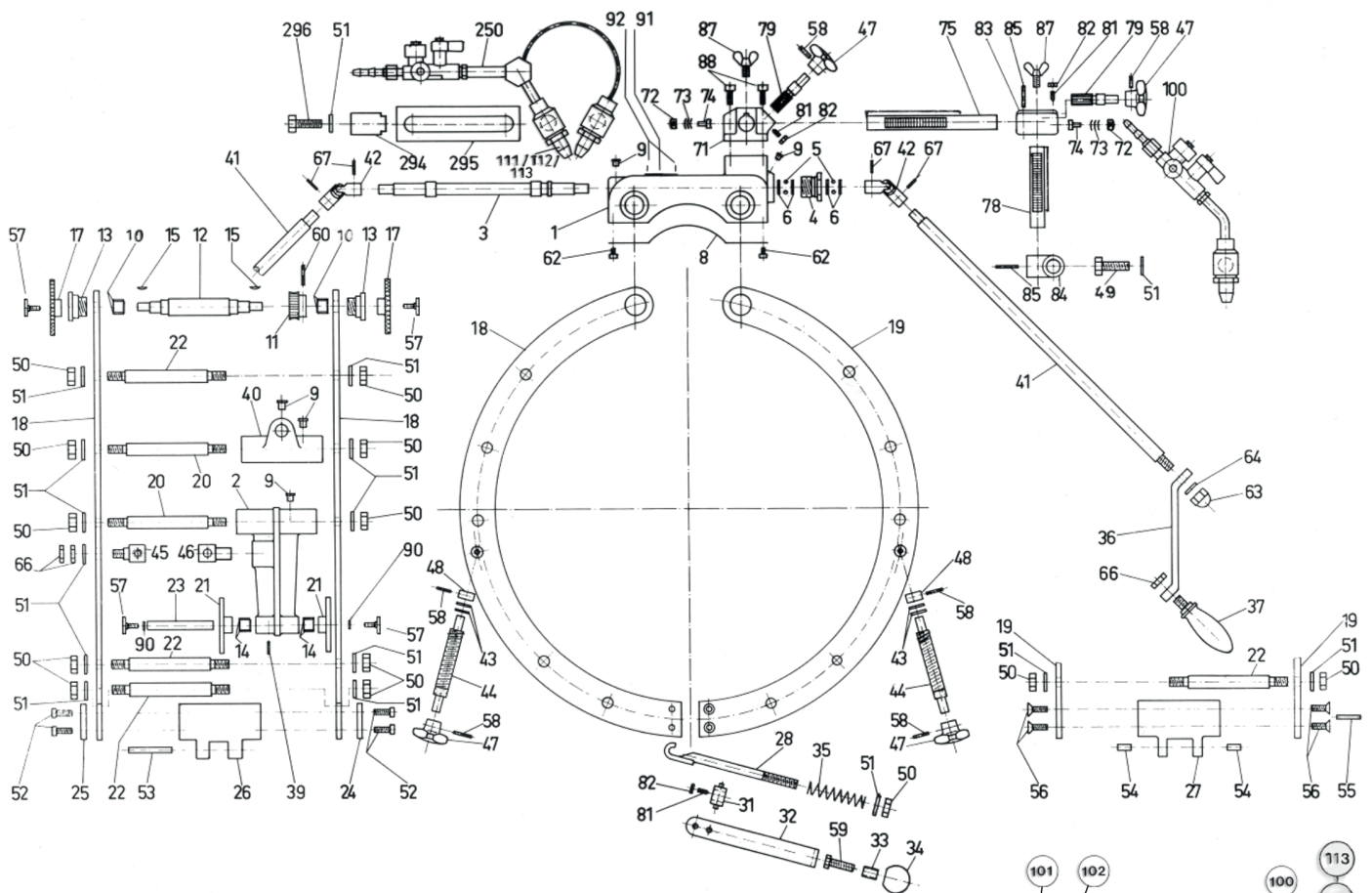

2840052-020

2336010-020E

2840052-020

2336010-020E

Special design
 Article: 233 5010-002
 Assembly torch adjustment cpl. pipe Size: 0-4
 Tooth rack 200 mm cpl. horizontal
 Tooth rack 400 mm cpl. vertical

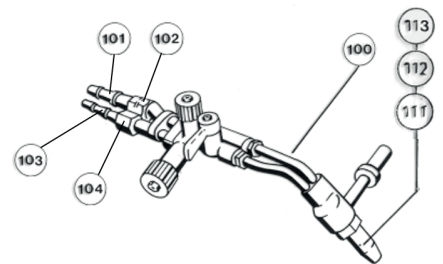

Subject to technical modifications 10/2018

Number	Order Number	Description
1	235 5010-001	Housing
2	235 5160-005	Lever link
3	235 5160-001	Worm shaft
4	235 5010-003	Bearing bush
5	040 2200-009	Steel ball Ø3mm
6	050 3509-002	Shim ring 11x17x1.0 mm
8	235 5010-005	Cover plate
9	030 0506-001	Lubricating nipple
10	040 0207-002	Needle assembly 12x16x13 TN
11	235 5010-006	Worm gear
12	235 5010-007	Shaft
13	235 5010-008	Guide bush
14	040 0207-001	Needle assembly 10x14x13 TN
15	050 4503-002	Spring washer 2x2.6 mm
17	235 6010-015	Drive gear
18 / 19	235 5160-006	Split ring
20	235 5010-024	Pin
21	235 5050-003	Roller
22	235 5050-004	Distance bolt
23	235 5010-026	Axis
24	235 5050-005	Rear guide
25	235 5050-006	Front guide
26	235 5050-007	Cover section
27	235 5050-008	Hinged section
28	234 5050-001	Clamping screw
31	235 5050-009	Joint component
32	235 5050-010	Bracket
33	235 5050-011	Sleeve
34	040 1302-008	Button
35	040 0102-040	Pressure spring
36	235 5010-010	Crank handle
37	040 0802-005	Handle
39	050 4101-011	Clamping sleeve
40	2345160-002	Guide for crank shaft
41	235 5160-002	Shaft
42	040 2002-002	Cardan joint
43	050 3509-001	Shim ring 9x15x1.0 mm
44	235 5050-012	Spindle
45	235 5010-028	Spindle nut
46	235 5010-029	Spindle holder
47	040 1401-003	Handwheel
48	050 3301-023	Setting ring 9x18x8
49	050 0110-052	Hexagon bolt M10x25
50	050 1901-010	Hexagon nut M10
51	050 3501-007	Washer 10.5
52	050 1002-016	Socket screw M6x20
53	050 4003-034	Close tolerance grooved pin 6x50

54	050 4003-020	Close tolerance grooved pin 6x14
55	050 4003-020	Close tolerance grooved pin 6x14
56	050 0910-028	Countersink M6x16
57	050 0702-055	Flat headed screw
58	050 4101-010	Clamping sleeve 3x18
59	050 0110-036	Hexagon bolt M8x35
60	050 4101-017	Clamping sleeve 4x24
62	050 0701-064	Slotted cheese head screw M4x6
63	050 2101-003	Cap nut M10
64	050 2901-006	Washer spring
66	050 1908-010	Hexagon nut M10 flat
67	050 4101-009	Clamping sleeve 3x16
71	235 6012-002	Horizontal guide
72	235 6010-012	Brake screw
73	050 3203-005	Plate spring 10x4.2x0.4x0.7
74	235 6010-011	Brake plug
75	235 6010-020	Toothed rack - horizontal
75-1	235 6010-019	Tooth rack - horizontal 400 mm Special design
78	235 6010-021	Toothed rack - vertical
78-1	235 6010-039	Tooth rack - vertical 300 mm Special design
78-2	235 6010-040	Tooth rack - vertical 200 mm Special design
78-3	235 6010-043	Tooth rack - vertical 400 mm Special design
79	235 6010-009	Setting pinion
81	050 1401-001	Set screw with half-dog point M4x12
82	050 1901-006	Hexagon nut M4
83	235 6011-003	Vertical guide
84	235 6010-004	Burner holder
85	050 4101-019	Clamping sleeve 4x28
87	050 1501-006	Wing screw M6x16
88	050 1002-008	Socket screw
90	050 3001-008	Toothed locked washer 5.1
91	235 5010-011	Type plate
92	050 4201-002	Round head grooved pin (brass) 1.4x4
100 a	231 4200-001	Cutting torch acetylene (without nozzle)
100 p	231 4220-001	Cutting torch propane (without nozzle)
101	0600 400-002	Hose socket 9 mm G3/8 heating gas
102	0600 401-020	Connecting nut G3/8LH heating gas
103	0600 400-003	Hose socket 6 mm G1/4 oxygen
104	0600 401-003	Connecting nut G1/4RH oxygen
111 a	235 3050-001	Block nozzle acetylene 3-10 mm
111 p	235 3060-001	Block cutting nozzle propane 3-10 mm
112 a	235 3050-002	Block nozzle acetylene 10-30 mm
112 p	235 3060-002	Block cutting nozzle propane 10-30 mm
113	235 3090-012	Heating nozzle propane und acetylene 3-100 mm
250	231 4260-001	Twin cutting torch acetylene (without nozzles)
294	235 5030-003	Bush
295	235 5030-002	Strap
296	050 0110-053	Hexagon bolt M10x30

Special design: Article 233 5010-002
Assembly torch adjustment cpl. pipe Size. 0-4
Tooth rack 200 mm cpl. horizontal
Tooth rack 400 mm cpl. vertical

Item	Order number	Description
1	040 1401-003	Handwheel C50
2	235 6010-009	Bevel 60 mm long
3	050 4101-010	Clamping sleeve 3x18
4	235 6010-011	Brake plug
5	235 6010-012	Brake screw
6	050 3202-005	Plate spring
7	235 6012-002	Horizontal guide
8	050 1002-009	Cylinder head screw M5x20
9	050 1501-006	Wing screw M6x16
10	050 1401-001	Set screw
11	050 1901-006	Hexagon nut M4 flat
12	235 6010-020	Tooth rack - horizontal 400 mm
13	235 6011-003	Vertical guide
14	050 4101-019	Clamping sleeve 4x28
15	235 6010-021	Tooth rack - vertical 200 mm
16	235 6010-004	Burner holder
17	050 3501-007	Disc
18	050 0110-052	Countersink M10x25