

# Spare Parts RSV-0

231 5010-001

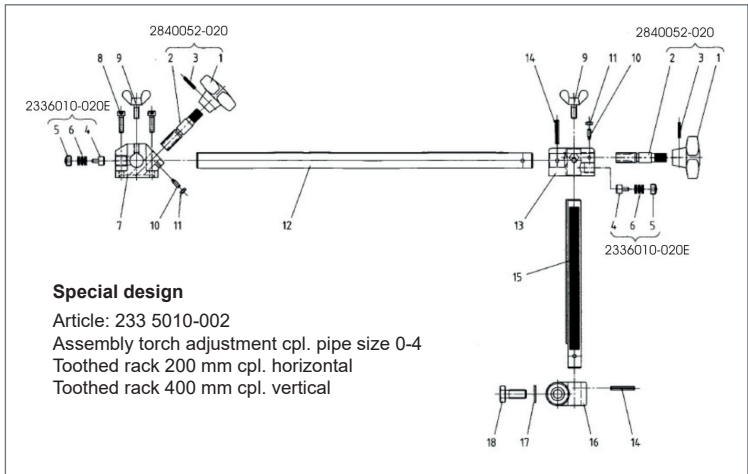
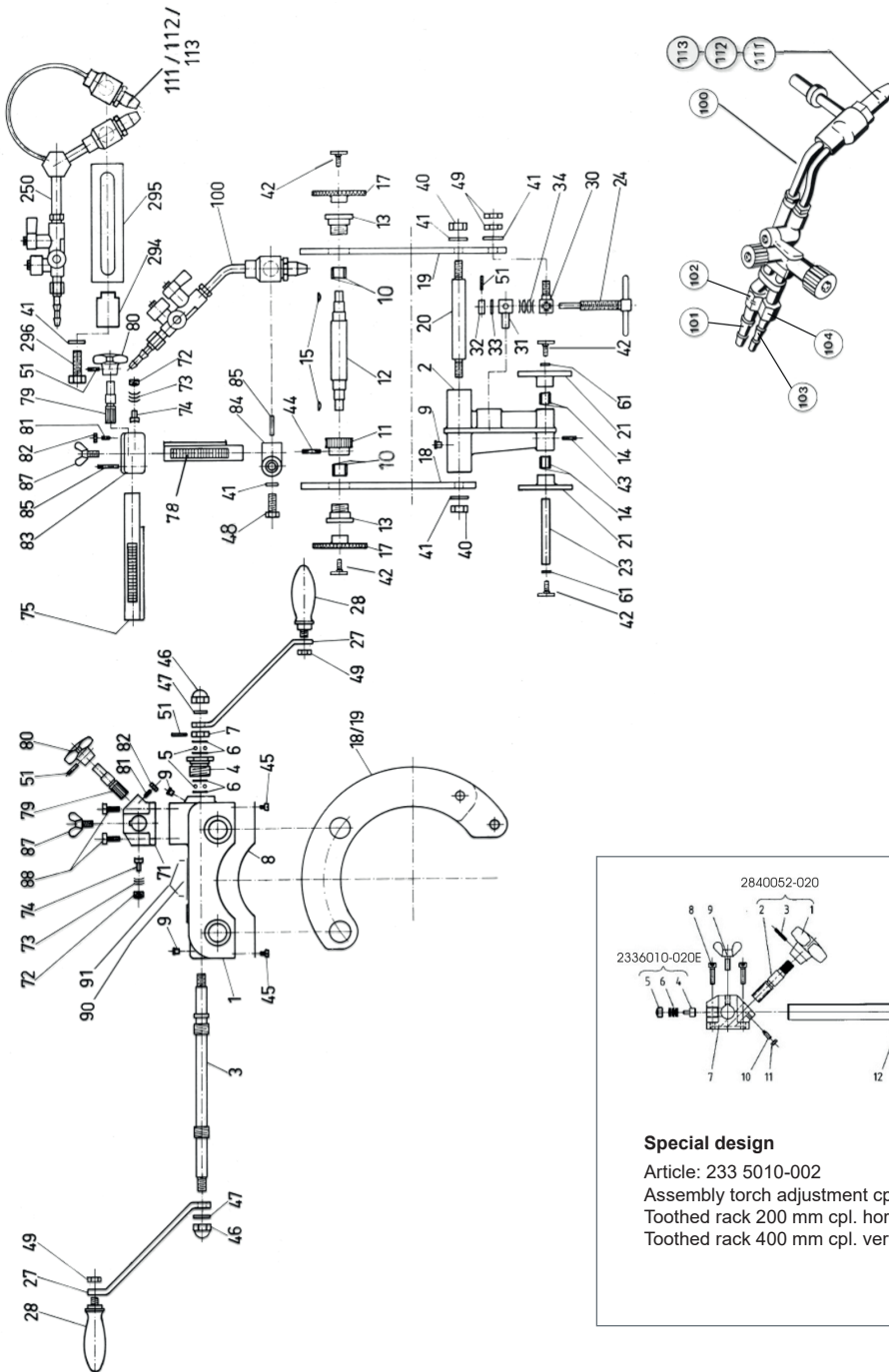

Subject to technical modifications 2021-03

## Single parts

Number	Order Number	Description	Part of assembly group:
1	235 5010-001	Housing	
2	235 5010-021	Lever link	B3
3	235 5010-002	Worm shaft	B2
4	235 5010-003	Bearing bush	B2
5	040 2200-009	Steel ball Ø3 mm	B2
6	050 3509-002	Shim ring 11x17x1.0 mm	B2
7	235 5010-004	Setting ring	B2
8	235 5010-005	Cover plate	
9	030 0506-001	Lubricating nipple	B3
10	040 0207-002	Needle assembly 12x16x13 TN	
11	235 5010-006	Worm gear	
12	235 5010-007	Shaft	
13	235 5010-008	Guide bush	
14	040 0207-001	Needle assembly 10x14x13 TN	B3
15	050 4503-002	Spring washer 2x2.6 mm	
17	235 5010-009	Drive gear	
18	235 5010-022	Split ring	
19	235 5010-023	Split ring	
20	235 5010-024	Pin	
21	235 5010-025	Roller	B3
23	235 5010-026	Axis	B3
24	235 5010-027	Spindle	B4
27	235 5010-010	Crank handle	B5
28	040 0802-005	Handle	B5
30	235 5010-028	Spindle nut	B4
31	235 5010-029	Spindle holder	B4
32	050 3301-023	Setting ring 9x18x8	B4
33	050 3509-001	Shim ring 9x15x1.0 mm	B4
34	050 3203-022	Plate spring H+S=1.4 mm / 18x9.2x1.0 mm	B4
40	050 1901-010	Hexagon nut M10	
41	050 3501-007	Washer 10.5	
42	050 0702-055	Flat headed screw	B3
43	050 4101-011	Clamping sleeve 3x20	B3
44	050 4101-017	Clamping sleeve 4x24	
45	050 0701-064	Cylinder head screw M4x6	
46	050 2101-003	Cap nut M10	
47	050 2901-006	Washer spring	
48	050 0110-051	Hexagon bolt M10x20	
49	050 1908-010	Hexagon nut M10 flat	B5
51	050 4101-010	Clamping sleeve 3x18	B4
61	050 3001-008	Toothed locked washer 5.1	B3
71	235 6012-002	Horizontal guide	B1
72	235 6010-012	Brake screw	B1

Number	Order Number	Description	Part of assembly group:
73	050 3203-005	Plate spring 10x4.2x0.4x0.7	B1
74	235 6010-011	Brake plug	B1
75	235 6010-020	Toothed rack - horizontal 185 mm	B1
75-1	235 6010-019	Tooth rack - horizontal 400 mm Special design	
78	235 6010-021	Toothed rack - vertical 115 mm	B1
78-1	235 6010-039	Tooth rack - vertical 300 mm Special design	
78-2	235 6010-040	Tooth rack - vertical 200 mm Special design	
78-3	235 6010-043	Tooth rack - vertical 400 mm Special design	
79	235 6010-009	Setting pinion	B1
80	040 1401-003	Handwheel C50	B1
81	050 1401-001	Set screw with half-dog point M4x12	B1
82	050 1901-006	Hexagon nut M4	B1
83	235 6011-003	Vertical guide	B1
84	235 6010-004	Burner holder	B1
85	050 4101-019	Clamping sleeve 4x28	B1
87	050 1501-006	Wing screw M6x16	B1
88	050 1002-008	Socket screw	
90	235 5010-011	Type plate	
91	050 4201-002	Round head grooved pin (brass) 1.4x4	
100 a	231 4200-001	Cutting torch acetylene (without nozzle)	
100 p	231 4220-001	Cutting torch propane (without nozzle)	
101	0600 400-002	Hose socket 9 mm G3/8 heating gas	
102	0600 401-020	Connecting nut G3/8LH heating gas	
103	0600 400-003	Hose socket 6 mm G1/4 oxygen	
104	0600 401-003	Connecting nut G1/4RH oxygen	
111 a	235 3050-001	Block nozzle acetylene 3-10 mm	
111 p	235 3060-001	Block cutting nozzle propane 3-10 mm	
112 a	235 3050-002	Block nozzle acetylene 10-30 mm	
112 p	235 3060-002	Block cutting nozzle propane 10-30 mm	
113	235 3090-012	Heating nozzle propane und acetylene 3-100 mm	
150	235 3010-017	Tip Cleaner 3-300 mm	
151	235 3090-023	Steel box for noozles (6 pieces)	
250	231 4260-001	Twin cutting torch acetylene (without nozzles)	
294	235 5030-003	Bush	
295	235 5030-002	Strap	
296	050 0110-053	Hexagon bolt M10x30	

## Assembly groups

Number	Order Number	Description	Includes the following parts:
B1	2335010-001	Torch adjustment complete	No. 71-75, 78, 79-85, 87
B2	2345230-010	Worm shaft complete	No. 3-7
B3	2345010-004	Lever complete	No. 2, 9, 14, 21, 23, 42, 43, 61
B4	2345010-003	Spindle complete	No. 24, 30-34, 51
B5	2345050-006	Crank complete	No. 27, 28, 49

**Special design: Article 233 5010-002**  
**Assembly torch adjustment cpl. pipe Size. 0-4**  
**Tooth rack 200 mm cpl. horizontal**  
**Tooth rack 400 mm cpl. vertical**

Item	Order number	Description
1	040 1401-003	Handwheel C50
2	235 6010-009	Bevel 60 mm long
3	050 4101-010	Clamping sleeve 3x18
4	235 6010-011	Brake plug
5	235 6010-012	Brake screw
6	050 3202-005	Plate spring
7	235 6012-002	Horizontal guide
8	050 1002-009	Cylinder head screw M5x20
9	050 1501-006	Wing screw M6x16
10	050 1401-001	Set screw
11	050 1901-006	Hexagon nut M4 flat
12	235 6010-020	Tooth rack - horizontal 400 mm
13	235 6011-003	Vertical guide
14	050 4101-019	Clamping sleeve 4x28
15	235 6010-021	Tooth rack - vertical 200 mm
16	235 6010-004	Burner holder
17	050 3501-007	Disc
18	050 0110-052	Countersink M10x25